Queens in Flight Local Art Program at JFK Terminal 6

Request for Proposals (RFP)

Release Date: July 9, 2025

Submission Deadline: August 29, 2025

Artists Notified by: October 27, 2025

Description

The Jamaica Center for Arts & Learning (JCAL), on behalf of JFK Millennium Partners (JMP), invites local Queens-based artists to submit proposals for the Queens in Flight Local Art Program at JFK Terminal 6 who meet one of the following criteria:

- a. Queens residents for at least twelve months, or;
- b. Artists who make art at the time of their submission out of a Queens-based studio or location, or;
- c. Artists who can demonstrate a strong personal or professional relationship to the borough.

This program will showcase the cultural and artistic diversity of Queens through contemporary art installed on in high-traffic areas of this new and expanded airport terminal. Artists selected will license their artwork and have the opportunity to display it before millions of global passengers, to provide signage and information on their work, portfolio, and art practice (e.g. QR codes), and to sell the displayed artwork if they choose. Artwork will be on display for 12 months, after which a new cohort of local artists will be selected to display their artwork.

The Art

Queens in Flight is not a commissioning program; this RFP is to surface only preexisting artworks by Queens-based artists that a) reflect the cultural and artistic diversity of Queens, and b) fit a prefabricated display case (2'6" by 5' wide and 7'8" tall). Any artwork that is considered for display may only "utilize statements, symbols or markings in the artworks submitted that are suitable for artworks to be displayed in a public space and in conformance with Port Authority standards and that do not violate the right of privacy or publicity of any third party."

Artist Fee

Each selected artist will receive a stipend of \$5,000.

Applicant Eligibility

Selected artists must:

- Be at least 16 years of age.
- At the time of their selection, provide proof of one of the following:
 - are current Queens residents for at least twelve months, or;
 - artists who make art at the time of their submission out of a Queens-based studio or location, or;
 - can demonstrate a strong personal or professional relationship to the borough.
- Make artwork available for license that reflects the cultural diversity and dynamism of Queens.
- Make artwork available that fits in a prefabricated display case.

While only artists who meet the eligibility requirements may apply, applicants of all races, colors, religions, languages, gender identities, sexual orientations, national origins, ages, disabilities, socioeconomic status, marital status, and all other protected categories are welcome and encouraged to apply.

Proposal Requirements

- **Cover Letter:** Provide a one-page cover letter (with name, snail/email address, phone number) explaining your interest in the Queens in Flight Local Art Program, and how your work as an artist will benefit from this program.
- **Artist Statement:** Provide a statement of no more than five hundred words (2 pages or less) detailing your artistic journey, the themes you explore in your work, and how your artwork aligns with the purpose and goals of the Queens in Flight Local Art program.
- **CV/Resume:** Provide a CV (if appropriate) or professional resume.
- **Portfolio:** Submit up to 3 high-quality images of preexisting artworks for consideration for the program.

Submission Deadline

Submit all proposals by 3:00 p.m. EST on Friday, August 29, 2025, to the Jamaica Center for Arts & Learning (JCAL), 161-4 Jamaica Ave, Jamaica, NY 11432. Late submissions will not be accepted.

All proposals must be submitted through Submittable at the following link:

<https://jcal.submittable.com/submit/331578/queens-in-flight-local-art-program-at-jfk-terminal-6>

Selection Process

A seven-member selection committee, comprising representatives from JCAL, JMP, the Port Authority, and local and national art experts, will evaluate submissions and select up to six artists whose work reflects Queens' cultural diversity.

Art Installation, Exhibition & Preservation

- Artwork preparation and installation logistics will occur in November of each year, and the artwork will be on display for 12 months.
- Art installation will be strategically placed in high-traffic areas of the airport that transit international passengers and provide signage and information (e.g., QR codes) where the traveling public can view and purchase the work on display. An introductory plaque or digital display near each artwork will provide information about the artist, the title, and a brief description or statement about the work.
- The artist will have the opportunity to sell the work on display, with such sale facilitated by JCAL.
- Each exhibit will be documented through high-quality photography and video to create an archive of the program for promotional purposes of future exhibitions. Artists' works will be featured on the Port Authority's JFK Airport T6 website, specifically on the Art page.
- All art placement, signage, and placement of QR codes must be approved by JMP and the Port Authority of New York and New Jersey.
-

Legacy and Continuation

JMP will document each exhibit through high-quality photography and video to create an archive of the program. This can be used for promotional purposes of future exhibitions. The Port Authority T6 Art webpage will feature artists' works.

Other Matters

- **Certification Process:** Selected artists must provide proof to have met the eligibility requirements spelled out in this RFP.
- **Contractual Agreements:** The contract for the artists will be between JMP and the Artist, facilitated by JCAL
- **Community Engagement:** An opening reception will be held for the new exhibition, inviting the community, airport staff, and travelers to celebrate the unveiling of the works. Promotional materials (flyers, social media campaigns, press releases) will be created to publicize the opening receptions and highlight the artists and their works.

About JFK Millennium Partners and Jamaica Center for Arts and Learning

JFK Millennium Partners (JMP)

Terminal 6 is an award-winning public-private partnership between the Port Authority of New York & New Jersey and JFK Millennium Partners (JMP) – a consortium that includes Vantage Airport Group, an industry leading investor, developer and manager of award-winning global airport projects,

including LaGuardia Airport's Terminal B; American Triple I, a certified minority-owned investor, owner, developer and manager of infrastructure assets; RXR, an innovative New York real estate investor and developer; and JetBlue Airways. As part of its agreement with the Port Authority, JMP also currently manages JFK Terminal 7, which will be demolished in 2026 when the second phase of Terminal 6 construction begins. For more information, visit <https://www.anewjfk.com/jmp-terminal6/>

Jamaica Center for Arts and Learning (JCAL)

Jamaica Center for Arts & Learning (JCAL), founded in 1972, is a multidisciplinary arts center based in the diverse community of Southeast Queens. Our mission is devoted to offering quality visual, and performing arts, and to providing accessible education programs to encourage participation in the arts. JCAL is open Tuesday through Saturday from 10am to 6pm; closed Sundays, Mondays, and major holidays. For additional information, call JCAL at 718-658-7400 or visit www.JCAL.org.

Appendix A

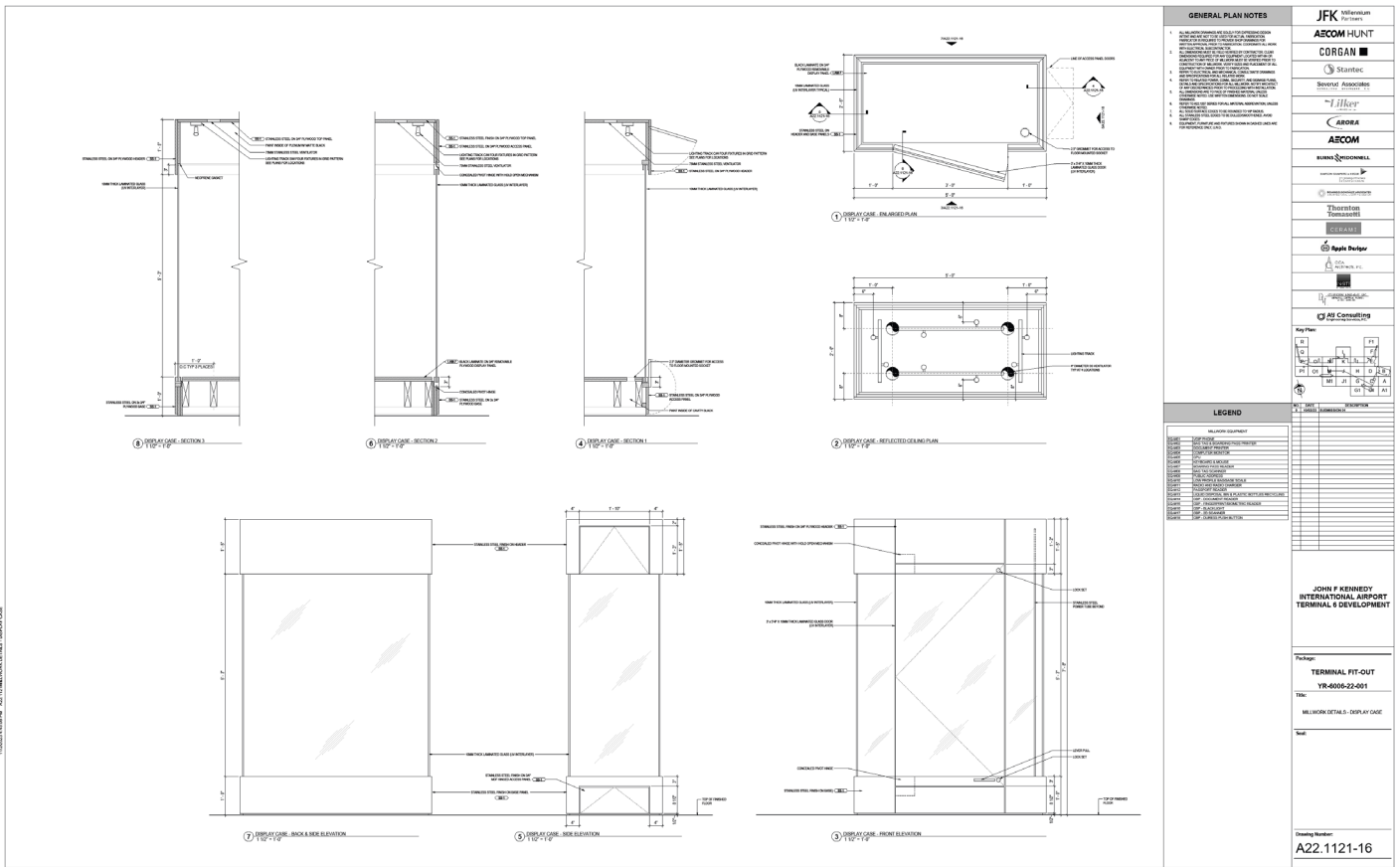

Display case dimensions.

Appendix B

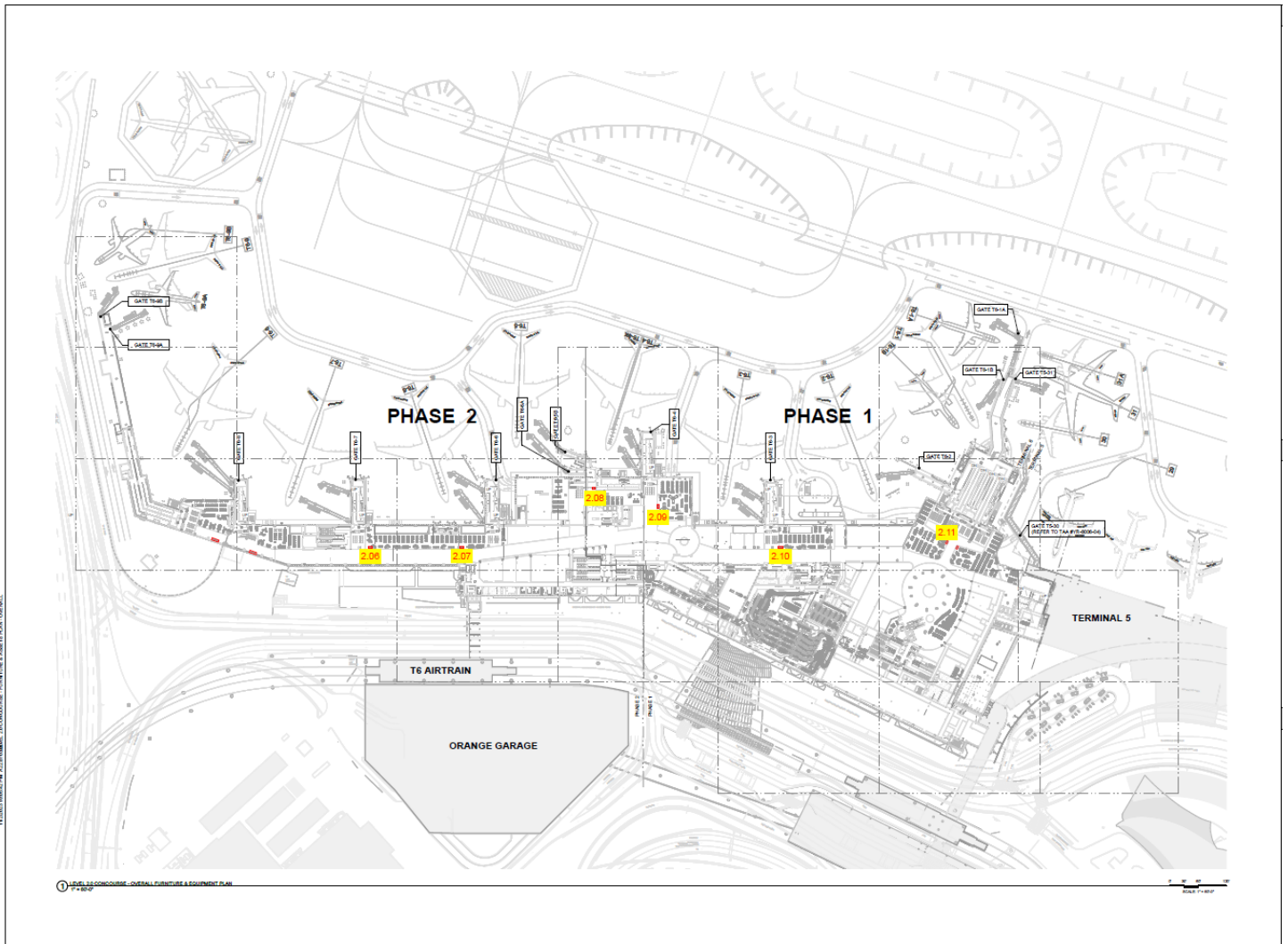

Location of display cases in T6